

# RED LINE FLATS

6205 N. College Ave  
Indianapolis, IN 46220  
(NEC of 62nd St. & College Ave.)

NEW MIXED-USE  
DEVELOPMENT  
RETAIL/COMMERCIAL

## FOR LEASE

**4,964 SF First Floor  
Space Available**

Fully Leased Office  
Headquarters,  
27 Apartments &  
Retail/Commercial Space  
Coming December 2022

**VERITAS  
REALTY**

[www.VeritasRealty.com](http://www.VeritasRealty.com)



**RETAIL SPACE FOR LEASE**

**CONTACT:**

**Amy Tharp**

E: [Amy@VeritasRealty.com](mailto:Amy@VeritasRealty.com)

T: 317-472-1800

**Camden Chadd**

E: [Camden@VeritasRealty.com](mailto:Camden@VeritasRealty.com)

T: 317-472-1800



# RETAIL/COMMERCIAL SPACE AVAILABLE | FOR LEASE

**RED LINE  
FLATS**

## PROPERTY HIGHLIGHTS:

- 4,964 SF of **First Floor Retail Space** for Lease with frontage to College Ave & 62nd Street
- Transformative 4-story mixed-use development with office, apartments and retail at the northeast corner of College Ave and 62nd Street
- Home to Eight Eleven Group's corporate headquarters (57,000 SF) with **+/-250 employees**
- 27 apartment units
- On-site underground parking spaces potentially available
- Transit-oriented development with close proximity to IndyGo's Red Line stop in Broad Ripple
- Located in the heart of Broad Ripple Village - a vibrant work, live, play community situated on the northside of Indianapolis
- Estimated December 2022 Completion Date

## 2021 DEMOGRAPHICS

	MILE 1	MILE 3	MILE 5
POPULATION	11,361	81,426	222,002
DAYTIME POP	4,841	27,768	131,498
HOUSEHOLDS	5,785	35,803	96,819
AVERAGE HH INCOME	\$128,449	\$103,933	\$83,513
MEDIAN HH INCOME	\$95,917	\$71,311	\$55,494
MEDIAN AGE	36.7	37.9	38

VIEW FROM COLLEGE AVE





# RED LINE FLATS



## NORTHEAST AERIAL VIEW - AUGUST 2022



# RETAIL/COMMERCIAL SPACE AVAILABLE | FOR LEASE

**RED LINE  
FLATS**

December 2022  
Completion



Corporate Headquarters  
57,000 SF  
250+ Employees





# RETAIL/COMMERCIAL SPACE AVAILABLE | FOR LEASE

RED LINE  
FLATS





# RETAIL/COMMERCIAL SPACE AVAILABLE | FOR LEASE

# RED LINE FLATS

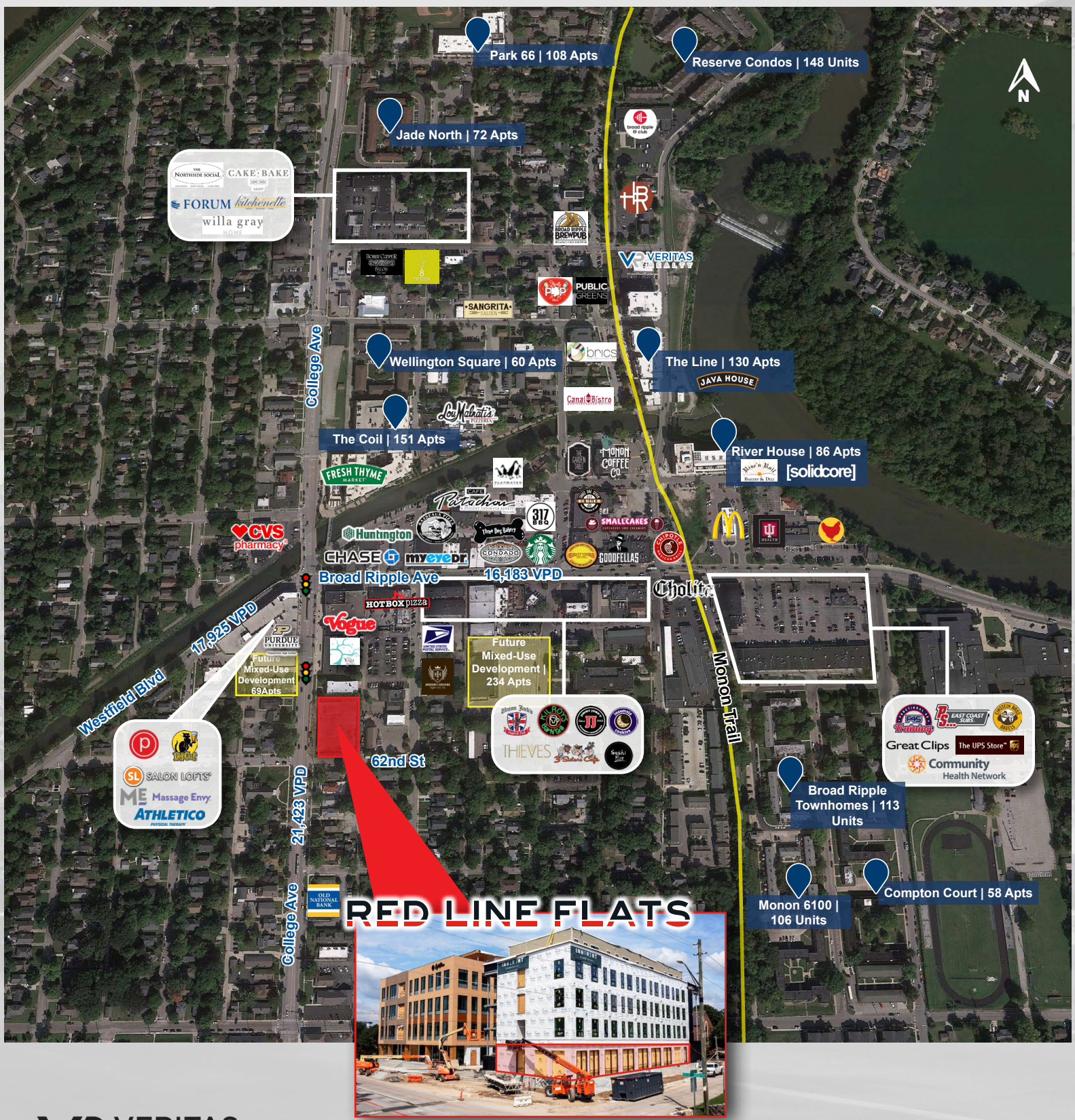



# RETAIL/COMMERCIAL SPACE AVAILABLE | FOR LEASE

**RED LINE  
FLATS**

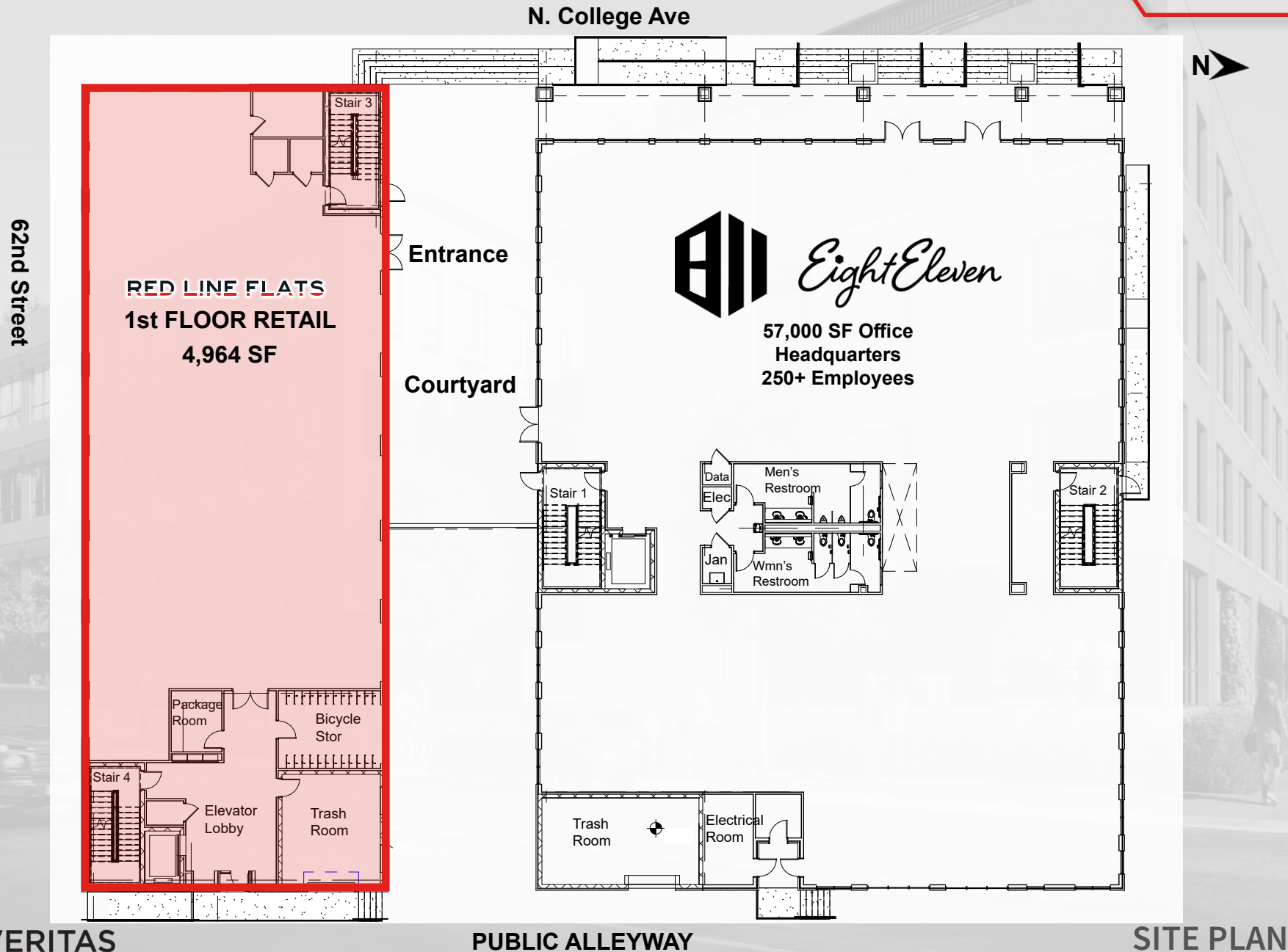



# RED LINE FLATS



**For More Information Contact:**

**Amy Tharp**

E: [Amy@VeritasRealty.com](mailto:Amy@VeritasRealty.com)

T: 317-472-1800

**Camden Chadd**

E: [Camden@VeritasRealty.com](mailto:Camden@VeritasRealty.com)

T: 317-472-1800

Information within this brochure has been obtained from sources believed reliable, but we make no representations or warranties, expressed or implied, as to the accuracy of the information. Prospective tenant and tenant representatives must verify the information and bears all risk for any inaccuracies as it relates to property and market information.