

Former O'Charley's Restaurant - For Lease

7640 North Shadeland Avenue, Indianapolis, IN 46250

Property Overview

Aerial (Market)

Aerial (Site)

Site Plan



Property Highlights:

- 7,484 SF Second Generation Restaurant with FF&E
- 1.59 acres total - Large parking field behind building
- Prime visibility on Shadeland Ave (27,069 AADT)
- Located in dense Indianapolis trade area serving Lawrence, Castleton, and Binford neighborhoods
- High daytime population with Community Hospital North nearby
- Close proximity to Lawrence North High School – +/-2,525 Students



DEMOGRAPHICS	1 miles	3 miles	5 miles
Population	7,975	54,661	182,041
Households	3,963	24,676	77,158
Average HH Income	\$70,933	\$87,404	\$87,411

FOR MORE INFORMATION
PLEASE CONTACT:

Amy Tharp

T: 317-472-1800

E: Amy@VeritasRealty.com

Andrew Demaree

T: 317-472-1800

E: ADemaree@VeritasRealty.com

VR VERITAS
REALTY

A MEMBER OF
CHAINLINKS
RETAIL ADVISORS

Former O'Charley's Restaurant - For Lease

7640 North Shadeland Avenue, Indianapolis, IN 46250

Property Overview

Aerial (Market)

Aerial (Site)

Site Plan



FOR MORE INFORMATION
PLEASE CONTACT:

Amy Tharp

T: 317-472-1800

E: Amy@VeritasRealty.com

Andrew Demaree

T: 317-472-1800

E: ADemaree@VeritasRealty.com

VR VERITAS
REALTY

A MEMBER OF
CHAINLINKS
RETAIL ADVISORS

Former O'Charley's Restaurant - For Lease

7640 North Shadeland Avenue, Indianapolis, IN 46250

Property Overview

Aerial (Market)

Aerial (Site)

Site Plan



FOR MORE INFORMATION
PLEASE CONTACT:

Amy Tharp

T: 317-472-1800

E: Amy@VeritasRealty.com

Andrew Demaree

T: 317-472-1800

E: ADemaree@VeritasRealty.com



Former O'Charley's Restaurant - For Lease

7640 North Shadeland Avenue, Indianapolis, IN 46250

Property Overview

Aerial (Market)

Aerial (Site)

Site Plan

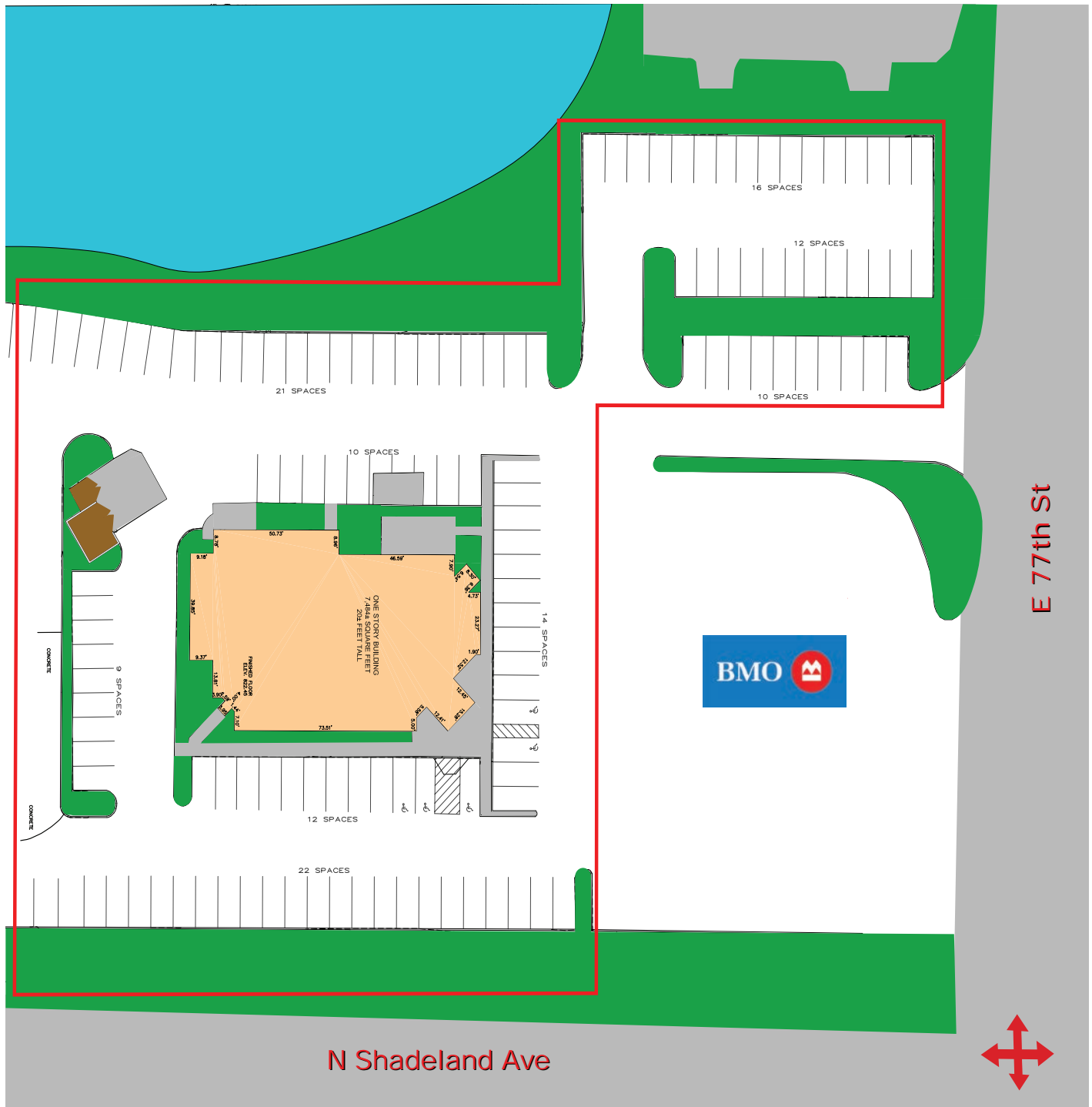

Information within this brochure has been obtained from sources believed reliable, but we make no representations or warranties, expressed or implied, as to the accuracy of the information. Prospective tenant and tenant representatives must verify the information and bears all risk for any inaccuracies as it relates to property and market information.

FOR MORE INFORMATION
PLEASE CONTACT:

Amy Tharp

T: 317-472-1800

E: Amy@VeritasRealty.com

Andrew Demaree

T: 317-472-1800

E: ADemaree@VeritasRealty.com

VERITAS
REALTY

A MEMBER OF
CHAINLINKS
RETAIL ADVISORS