

# Pock Farms (Anson Trade Area)

## Up to 27 Acres for Ground Lease, BTS, or Sale

6125 S 700 E, Zionsville, IN 46075

Aerial (Market)

Project Overview

Aerial (Site)



### Property Highlights:

- +/- 27 Acres for Ground Lease, BTS, or Sale
- Premier out-lot opportunities: +/- 350' of depth and ample frontage to Whitestown Pkwy
- Last major undeveloped parcel in the Anson trade area, a new and growing retail corridor serving the greater Zionsville & Whitestown communities
- Conveniently located near the Anson Development which is a 1,700 acre mixed-use community encompassing a Master Plan of 2,500+ residential units and 13 million sq. ft. of office, industrial, medical hospitality and retail
- Heavy daytime traffic generated by Meijer, Witham Health, Lowe's and AllPoints at Anson Business Park
- Located in self-contained TIF district

DEMOGRAPHICS	3 miles	5 miles	7 miles	10 miles
Population	22,047	41,088	82,853	267,654
Population Growth % (2010-2019)	52.17%	32.24%	24.82%	13.97%
Households	7,369	14,633	29,510	103,380
Avg. HH Income	\$158,429	\$160,289	\$150,239	\$108,416



# Pock Farms (Anson Trade Area) Up to 27 Acres for Ground Lease, BTS, or Sale

6125 S 700 E, Zionsville, IN 46075

Aerial (Market)

Project Overview

Aerial (Site)

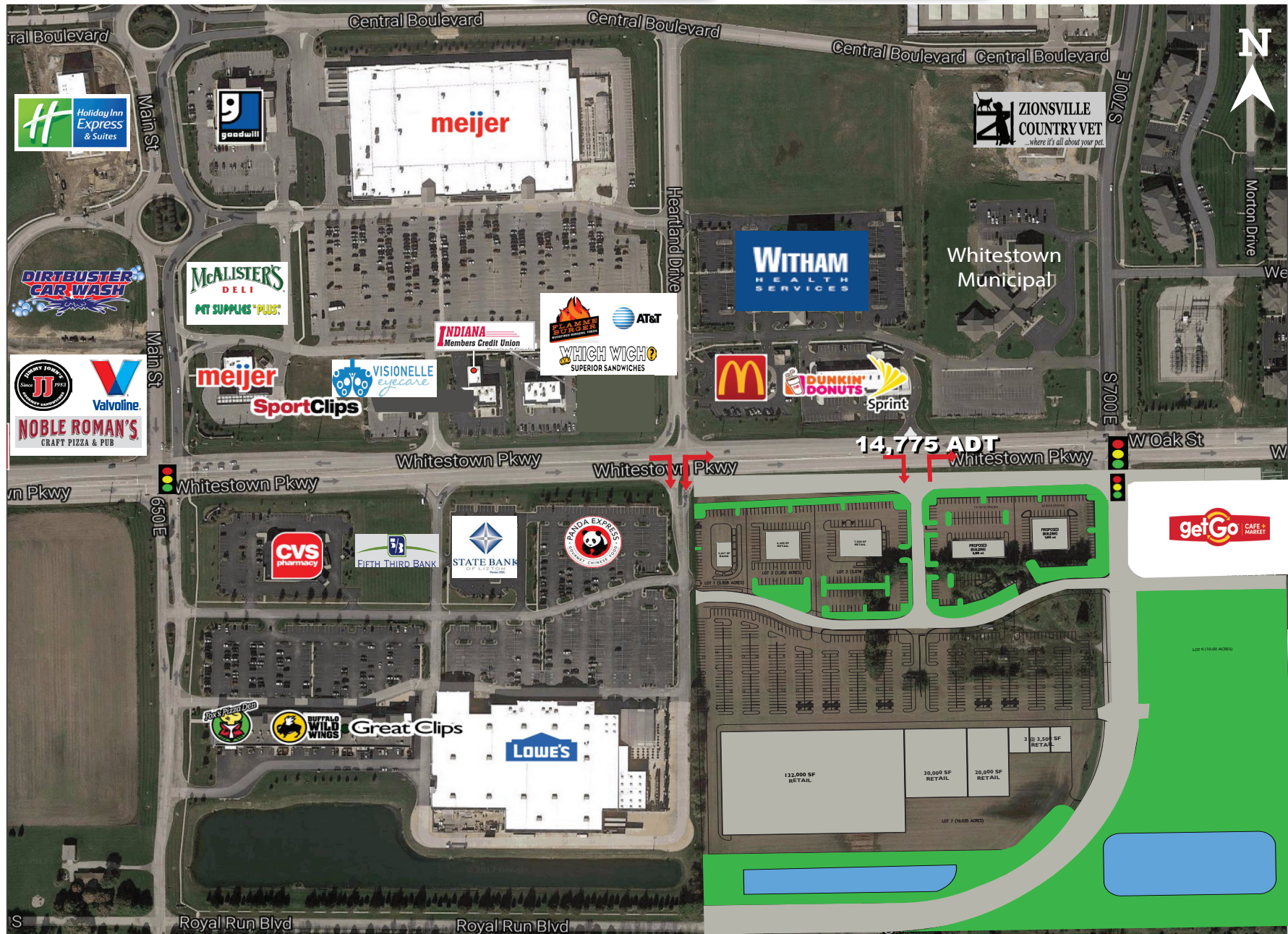

# Pock Farms (Anson Trade Area)

## Up to 27 Acres for Ground Lease, BTS, or Sale

6125 S 700 E, Zionsville, IN 46075

Aerial (Market)

Project Overview

Aerial (Site)



Lot	Tenant	Size
1	Available	0.808 Acres
2	Available	1.202 Acres
3	Available	2.076 Acres
4	Available	1.80 Acres
5	Available	1.20 Acres
6	Available	10.00 Acres
7	Available	19.035 Acres



**Andrew Demaree**

317.472.1800

ADemaree@VeritasRealty.com

**Seth Biggerstaff**

317.472.1800

Seth@VeritasRealty.com

**Amy Tharp**

317.472.1800

Amy@VeritasRealty.com

Information within this brochure has been obtained from sources believed reliable, but we make no representations or warranties, expressed or implied, as to the accuracy of the information. Prospective tenant and tenant representatives must verify the information and bears all risk for any inaccuracies as it relates to property and market information.