

# Downtown Indianapolis | Prime Retail Opportunity

## 4,100 - 8,400 SF For Lease

10 E Washington St, Indianapolis, IN 46204

Overview

Aerial (Market)

Trade Area

Floor Plans

Contact Info



DEMOGRAPHICS	1 miles	2 miles	3 miles
Population	15,811	49,452	102,939
Daytime Population	102,239	165,853	193,351
Employee Pop. Ratio	647	335	188

### Property Highlights:

- 4,100 sq. ft. of storefront retail For Lease (inclusive of 4,300 sq. ft. of lower level retail/restaurant space)
- Frontage to The Cultural Trail in Indianapolis' Central Business District
- Positioned between Chipotle and Charblue Steakhouse and Seafood; neighboring tenants include Jimmy Johns, Qdoba, Five Guys and more
- Densely populated urban core with high pedestrian foot-traffic
- Blocks away from Bankers Life Fieldhouse, Indiana Convention Center, Lucas Oil Stadium, Circle Centre Mall, Cummins HQ, and Flaherty and Collins' Market 360





# Downtown Indianapolis | Prime Retail Opportunity

## 4,100 - 8,400 SF For Lease

10 E Washington St, Indianapolis, IN 46204

Overview

Aerial (Market)

Trade Area

Floor Plans

Contact Info

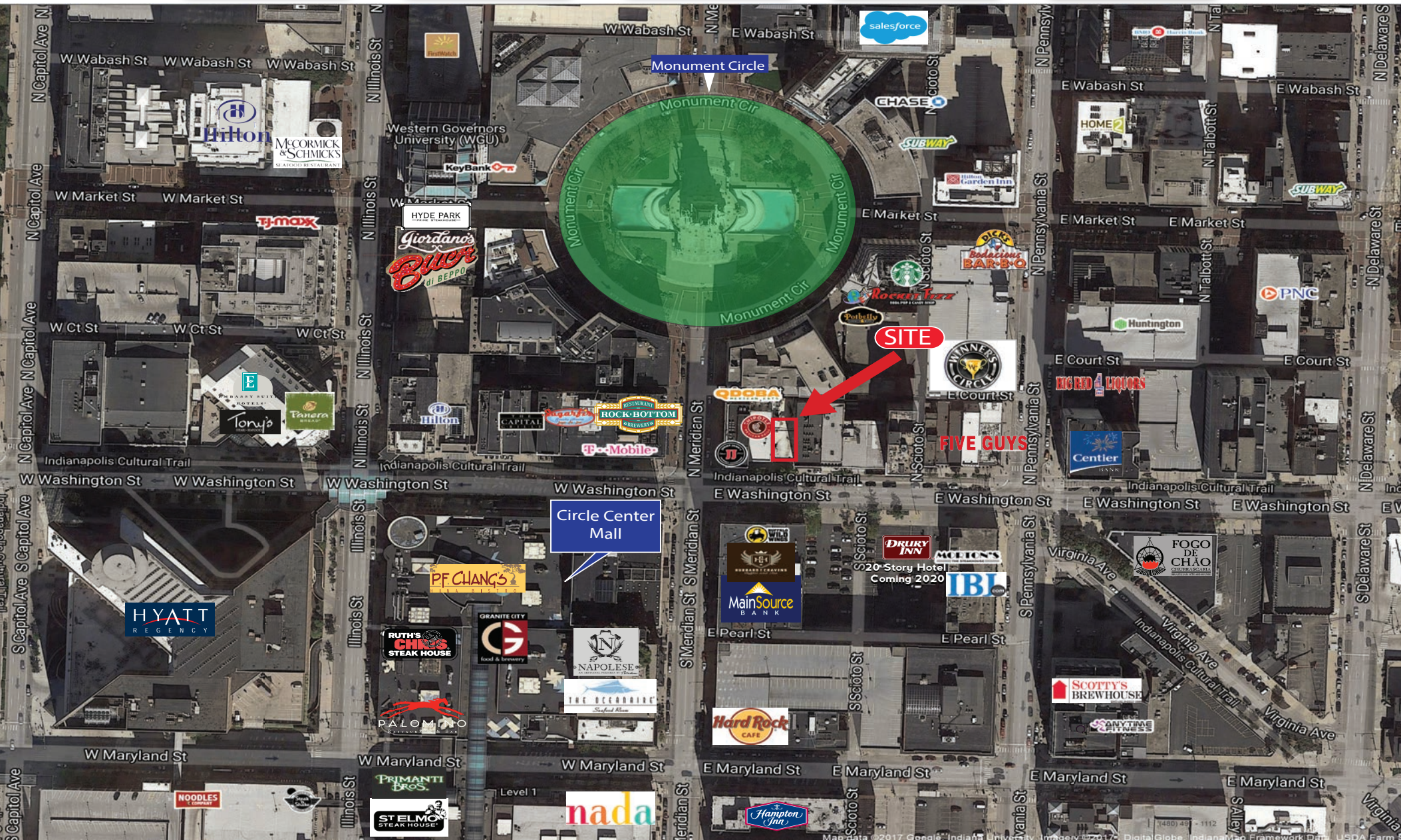



# Downtown Indianapolis | Prime Retail Opportunity

## 4,100 - 8,400 SF For Lease

10 E Washington St, Indianapolis, IN 46204

Overview

Aerial (Market)

Trade Area

Floor Plans

Contact Info

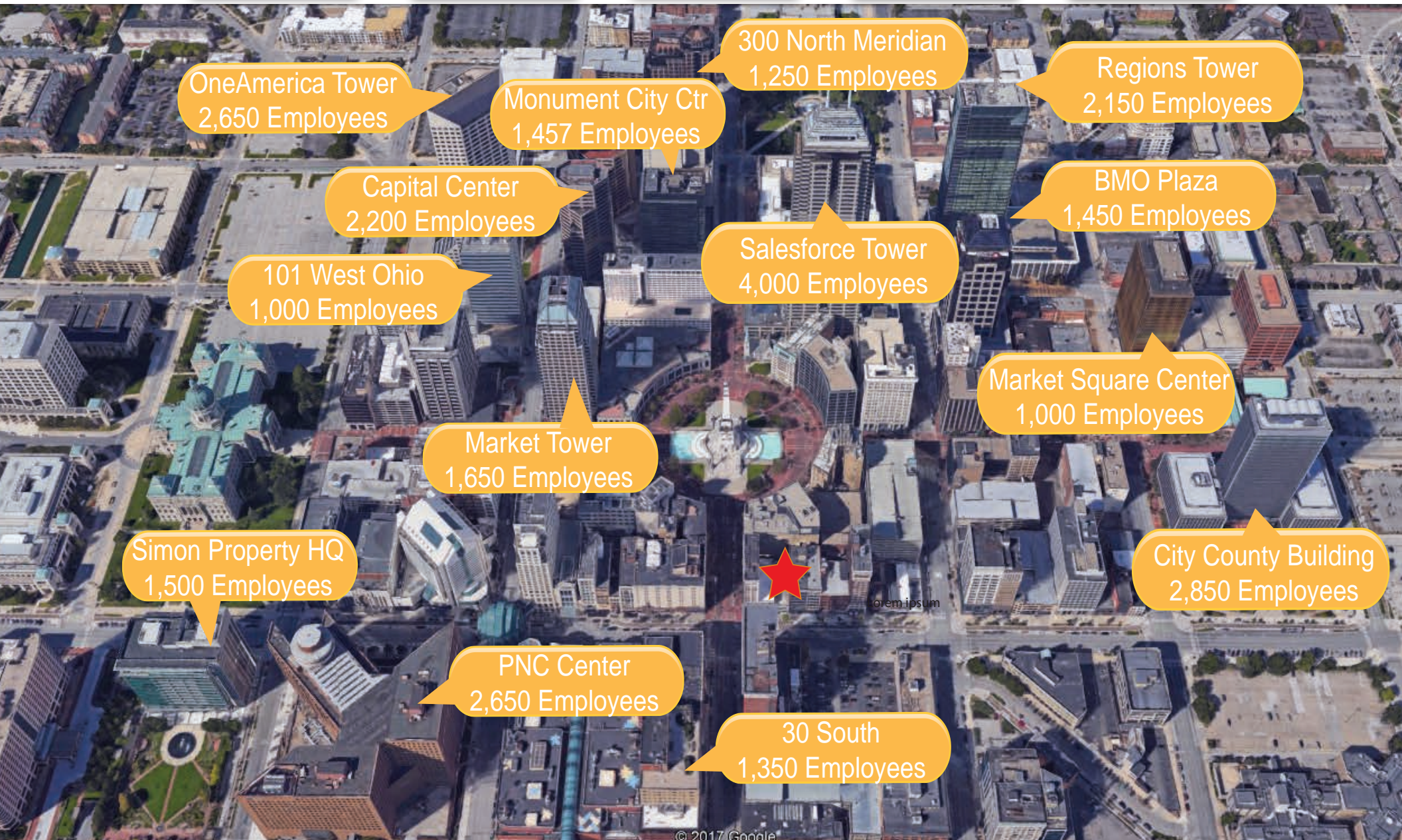

OneAmerica Tower  
2,650 Employees

Monument City Ctr  
1,457 Employees

300 North Meridian  
1,250 Employees

Regions Tower  
2,150 Employees

Capital Center  
2,200 Employees

BMO Plaza  
1,450 Employees

101 West Ohio  
1,000 Employees

Salesforce Tower  
4,000 Employees

Market Square Center  
1,000 Employees

Market Tower  
1,650 Employees

Simon Property HQ  
1,500 Employees

City County Building  
2,850 Employees

PNC Center  
2,650 Employees

30 South  
1,350 Employees

# Downtown Indianapolis | Prime Retail Opportunity

## 4,100 - 8,400 SF For Lease

10 E Washington St, Indianapolis, IN 46204

Overview

Aerial (Market)

Trade Area

Floor Plans

Contact Info

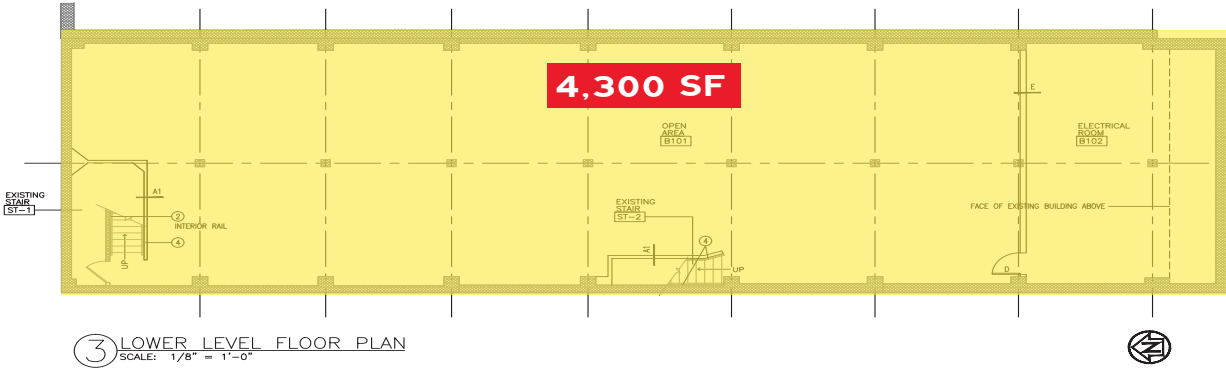
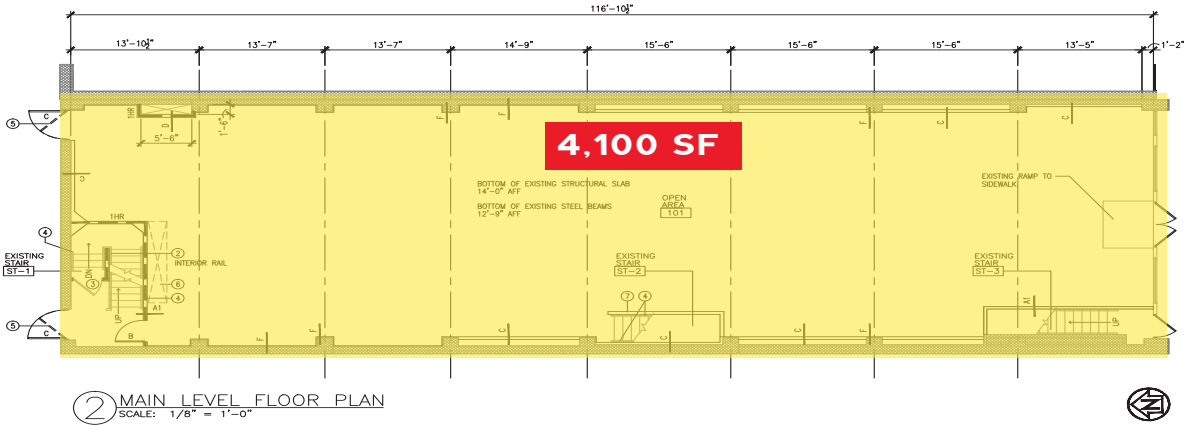



Overview

Aerial (Market)

Trade Area

Floor Plans

Contact Info



**VR** VERITAS  
REALTY

A MEMBER OF  
**CHAINLINKS**  
RETAIL ADVISORS

**Andrew Demaree**

317.472.1800

[ADemaree@VeritasRealty.com](mailto:ADemaree@VeritasRealty.com)