

Retail Outlot For Sale

0.80+/- Acres: 115' wide x 305' deep

3685 W. 86th Street, Indianapolis, IN 46268



Property Highlights:

- 0.80+/- acre parcel available for sale: 115' wide x 305' deep
- Zoning is C-4 Classification
- Located on the southwest quadrant of W 86th St & Michigan Rd
- Great visibility and exposure to over 95,000 vehicles per day
- Area retailers include Wal-Mart, Sam's Club, Costco, Lowe's, JCPenney, Goodwill, Office Depot, Staples, and more
- Daytime population within one mile radius is over 19,219

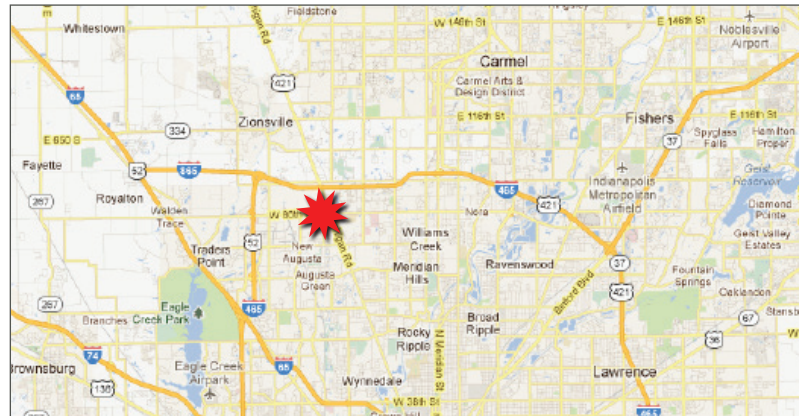

Demographics	1 mile	3 mile	5 mile
Estimated Population	7,240	59,926	145,184
Daytime Population	19,219	105,117	197,947
Est. Avg. HH Income	\$65,491	\$86,513	\$107,612

FOR MORE INFORMATION
PLEASE CONTACT:

Kyle Hughes

T: 317-472-1800 E: KHughes@VeritasRealty.com



Retail Outlot For Sale

0.80+/- Acres: 115' wide x 305' deep

3685 W. 86th Street, Indianapolis, IN 46268

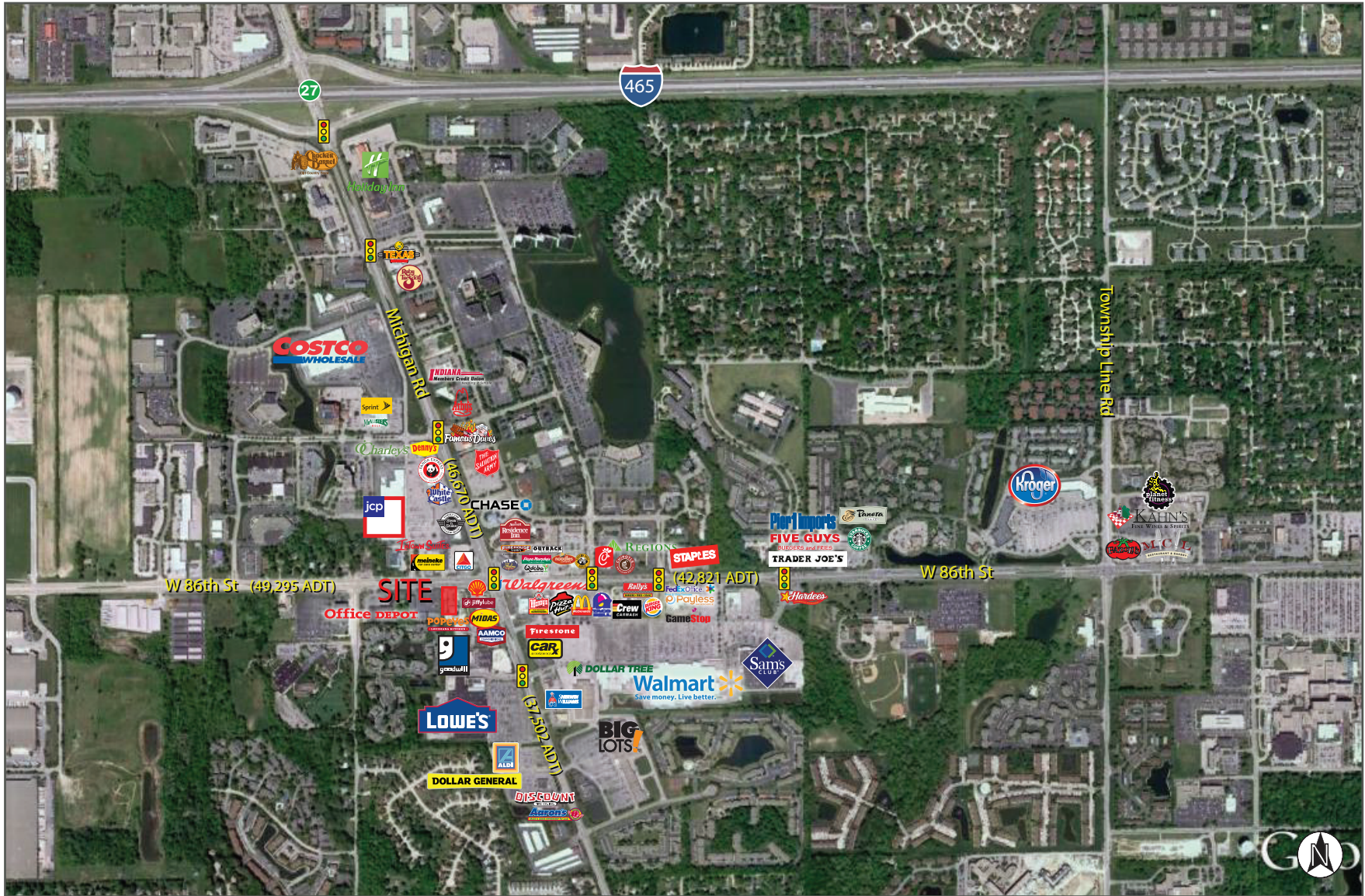

FOR MORE INFORMATION
PLEASE CONTACT:

Kyle Hughes

T: 317-472-1800 E: KHughes@VeritasRealty.com

VR VERITAS
REALTY

A MEMBER OF
CHAINLINKS
RETAIL ADVISORS