

INNOVATIVE
INVITING
INVIGORATING



NEXUSPARK REDEVELOPMENT

RETAIL SPACE AVAILABLE | FOR LEASE

For Information Contact: **Patricia Tesluk**
E: Ptesluk@ccim.net
T: 317-789-8181

VR VERITAS
REALTY
www.VeritasRealty.com

NEXUSPARK RETAIL SPACE AVAILABLE | FOR LEASE

PROPERTY OVERVIEW

INNOVATIVE ■ INVITING ■ INVIGORATING

- **Inviting** - Welcome to the most diverse mixed-use project where health, sports, fun, learning and shopping share a common platform
- NexusPark is a transformative redevelopment project of the former Fair Oaks Mall
- NexusPark will be a go-to community destination for the convergence of healthcare, recreation and wellness
- **Innovative** - All things in one place. Innovative design melds a wellness facility, exercise, rehab center and sports facility into a transformative destination for recreation and tourism alike.
- For QSR retail and service establishments this is a market that cannot be overlooked. The daily traffic plus the thousands of visitors to the Fieldhouse will be a formidable ground in which to grow and expand your business. Take advantage of the built in 1,200+ customers every week day and 10,000 visitors on the weekends.

DEMOGRAPHICS

	3 MILE	5 MILE	10 MILE
Population:	40,464	51,124	79,716
Daytime Population:	36,464	42,961	61,186
Households:	16,898	20,866	31,663
Avg. Household Income:	\$75,533	\$79,518	\$84,494

RENDERING
Exterior Park at 25th Street



RENDERING
150,000 SF Sports Fieldhouse



RENDERING
Exterior Front Entrance



NEXUSPARK RETAIL SPACE AVAILABLE | FOR LEASE

RETAIL SITE PLAN

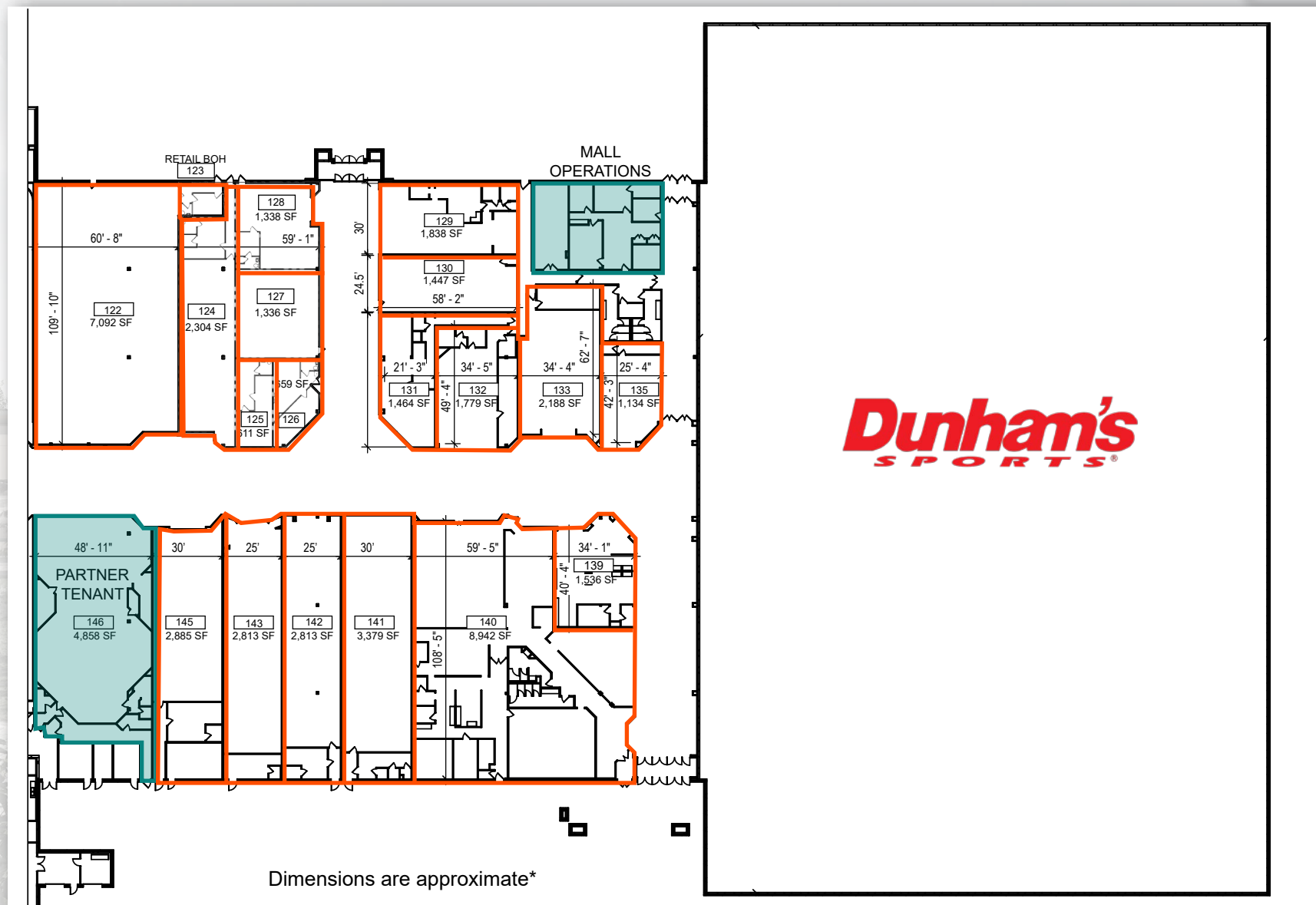

Dunham's
SPORTS®

NEXUSPARK RETAIL SPACE AVAILABLE | FOR LEASE

PROJECT SITE PLAN

During the construction phase, you can select your optimal location and plan to open in tandem with Columbus Regional Health and/or the Fieldhouse. The mood will be electric for the Grand Opening of both. You will not want to miss the opportunity. These opportunities are certain to **invigorate** or **ignite** your bottom line.



- Office and treatment hub
- ~220 staff and employees (M-F)
- ~1,000 visits per day

FIELDHOUSE

- 40,000 + visits per month during peak season , 15% local and 85% regional
- 1.5 full size soccer fields or up to 16 basketball courts
- Local Users weekdays – mainly middle and high schools with some college
- Regional users on weekends – mostly travel teams and tournaments

RETAIL
SEE PAGE 3
SITE PLAN

Dunham's
SPORTS

FITNESS & MULTIPURPOSE AREA

- Fitness Center (5a -10p daily)
- Mall Walkers (mainly seniors daily)
- Summer programming (May – August mainly kids)
- Community meetings
- Park Office (10 employees)

**OUTDOOR
PARK AREA**
+/- 3 ACRES

*All visit estimates based on design and programming
assumptions subject to change*

MARKET AERIAL



NEXUSPARK RETAIL SPACE AVAILABLE | FOR LEASE

CONSTRUCTION SCHEDULE



INNOVATIVE

■ INVITING ■

INVIGORATING

INNOVATIVE

All things in one place. Innovative design melds a wellness facility, exercise, rehab center and sports facility into a transformative destination for recreation and tourism alike.

INVITING

Welcome to the most diverse mixed-use project where health, sports, fun, learning and shopping share a common platform.

INVIGORATING

Play with the best. Enjoy sports local, regional and national tournaments plus an event center that can host everything from a high school graduation, wedding or a regional business expo. The options are endless.



For More Information Contact:

Patricia Tesluk

E: Ptesluk@ccim.net

T: 317-789-8181

Information within this brochure has been obtained from sources believed reliable, but we make no representations or warranties, expressed or implied, as to the accuracy of the information. Prospective tenant and tenant representatives must verify the information and bears all risk for any inaccuracies as it relates to property and market information.